

| ITEM NO. | PART NUMBER | DESCRIPTION | QTY. |
|----------|----------------|---------------------------|------|
| 1 | AD-6801 10-12 | ADAPTER 10MJ x 12MP 90 | 1 |
| 2 | AD-6500 10-10 | 10FJ x 10MJ 90, ADAPTER | 1 |
| 3 | AD-4603 16-20 | 45 DEG ADAPTER BEADED MPT | 1 |
| 4 | PU-15433 PLATE | MOUNTING ADAPTER | 1 |
| 5 | PU-MA6ACU | 2 GROOVE CLUTCH | 1 |
| 6 | PU-CP16 65C 05 | SIDE PORT PUMP ONLY | 1 |
| 7 | EL-SK-100 | PUMP SWITCH KIT | 1 |

| REVISIONS | | | |
|-----------|---|-----------|----------|
| REV. | DESCRIPTION | DATE | APPROVED |
| A | INITIAL RELEASE | 3/1/2013 | |
| B | UPDATED PART NUMBERS AND ADDED ITEM NO. 7 | 11/7/2023 | KD (BB) |

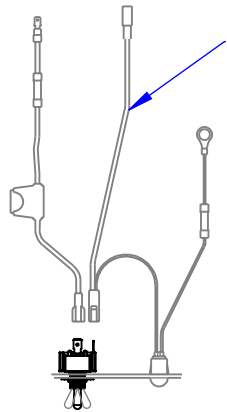

EL-SK-100: QTY 1
"SWITCH KIT, DASH"
SEE DWG 10-0931-14
FOR MORE DETAILS

PU-SP4-11-45

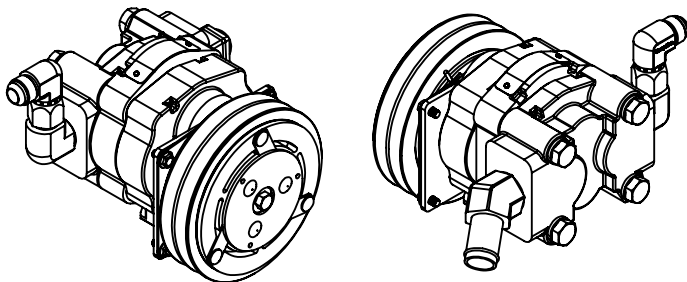
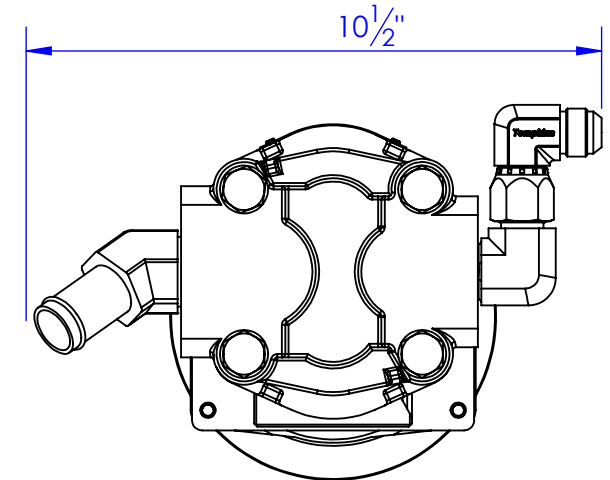
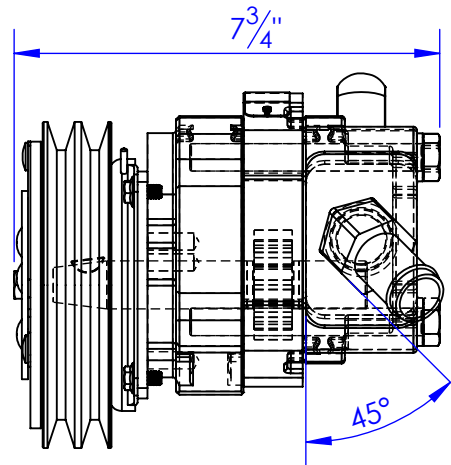
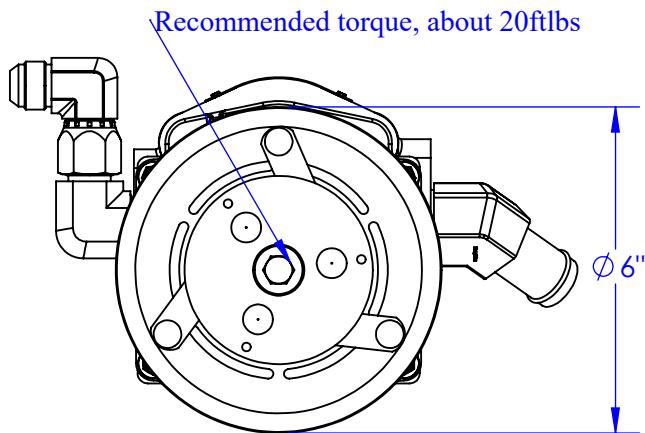
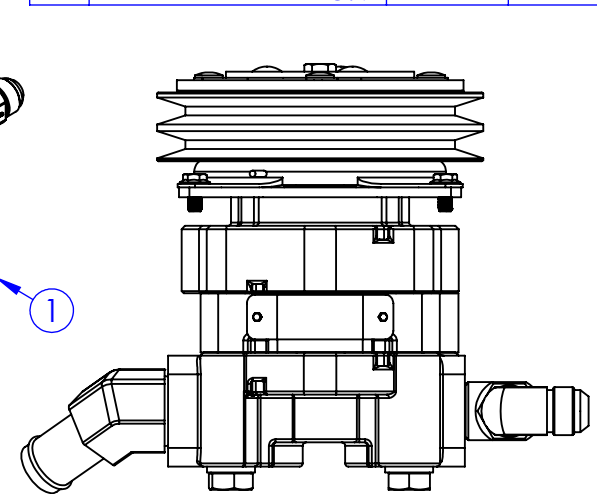
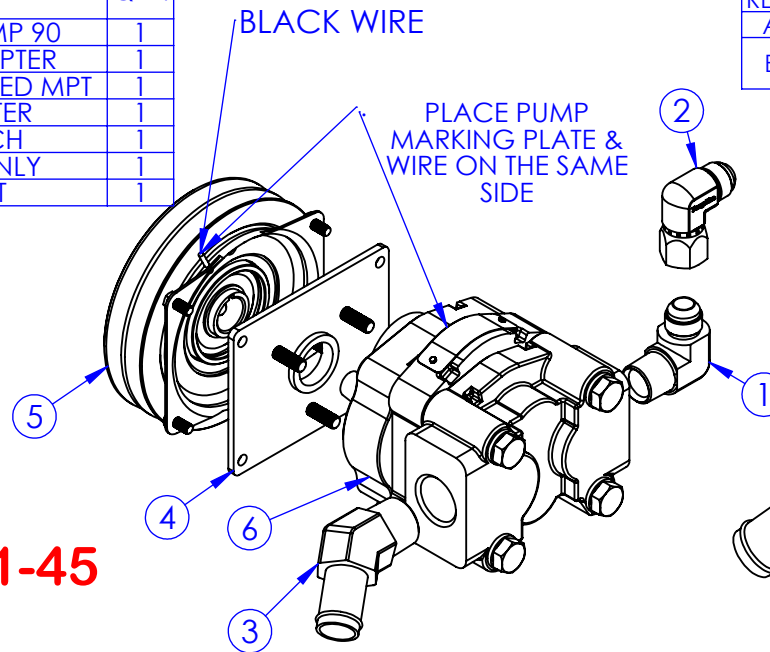

PROPRIETARY AND CONFIDENTIAL
THE INFORMATION CONTAINED IN THIS
DRAWING IS THE SOLE PROPERTY OF TRIPLE
C INC. ANY REPRODUCTION IN PART OR
AS A WHOLE WITHOUT THE WRITTEN
PERMISSION OF TRIPLE C INC. IS PROHIBITED.

DIMENSIONS ARE IN INCHES
TOLERANCES:
FRACTIONAL $\pm 1/16$
ANGULAR: MACH ± 1 BEND \pm
TWO PLACE DECIMAL ± 010
THREE PLACE DECIMAL ± 005

MATERIAL ---
DO NOT SCALE DRAWING

| NAME | DATE |
|--|-----------|
| DRAWN HEATH | 11/7/2023 |
| PART # PU-SP4-11-45 | |
| ASM # | |
| COMMENTS: 2 GROOVE SIDE PORT PARKER PUMP 45 DEGREE | |

P.O. BOX 248,
SABETHA, KS 66534



| SIZE | DWG. NO. | REV. |
|--------------|---------------------|--------------|
| A | 10-0931-08 B | B |
| SCALE: 1:3.5 | WEIGHT: --- | SHEET 1 OF 1 |